



**LEGEND**

- LOWEST SURVEYED SLOPE
- GROUND LEVEL
- - - - MOST LIMITING OBSTACLE
- ① OBSTACLE

**NOTES**

1. AZIMUTH AND COORDINATES FOR THIS SURVEY ARE BASED ON MGA (GDA2020) ZONE 53 THE VERTICAL DATUM BEING AHD.
2. HORIZONTAL DIMENSIONS IN METRES (FEET) ELEVATIONS IN FEET
3. USERS OF THIS CHART SHOULD NOTIFY ANY ERRORS OR OMISSIONS AS SOON AS THEY BECOME APPARENT TO :-  
  
AERONAUTICAL INFORMATION SERVICE - AIR FORCE  
EMAIL: AIS.AF@DEFENCE.GOV.AU
4. FOR FURTHER INFORMATION REGARDING THIS CHART CONTACT THE ABOVE
5. MAGNETIC VARIATION 2° 46' E (JULY 2024)
6. AERIAL SURVEY COMPLETED OCTOBER 2023.  
GROUND SURVEY CHECKS AND VERIFICATION MAY 2024.

**LEGEND**

- OBSTRUCTIONS AND OBSTACLES**
- ① OBJECT NUMBER
  - 392 TOP ELEVATION IN FEET
  - TREE(S) OR VEGETATION
  - BUILDING OR LARGE STRUCTURE
  - POLE, TOWER, SPIRE ETC
  - △ ANTENNA
  - MOVING (ROADS, RAILWAY TRACKS ETC)
  - TERRAIN PENETRATING LOWEST SURVEYED SLOPE
  - OVERHEAD TRANSMISSION LINE
  - FENCE LINE
  - - - FOREST AREAS PENETRATING LOWEST SURVEYED SLOPE

DECLARED DISTANCES FOR RUNWAY 14	
TAKE OFF RUN AVAILABLE (TORA)	3352m (10997')
TAKE OFF DISTANCE AVAILABLE (TODA)	3497m (11473') 1.93%
ACCELERATE STOP DISTANCE AVAILABLE (ASDA)	3352m (10997')
LANDING DISTANCE AVAILABLE (LDA)	3352m (10997')
SUPPLEMENTARY TAKE OFF DISTANCE AVAILABLE (STODA)	3324m (10905') 1.6%, 3489m (11446') 1.9%

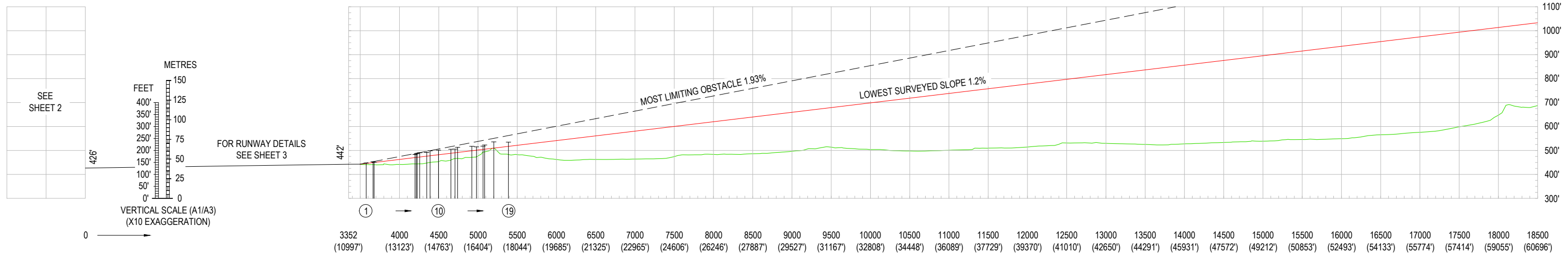

**RUNWAY 14**

1:25000 (A1)  
1:50000 (A3)  
SCALE 1:25000

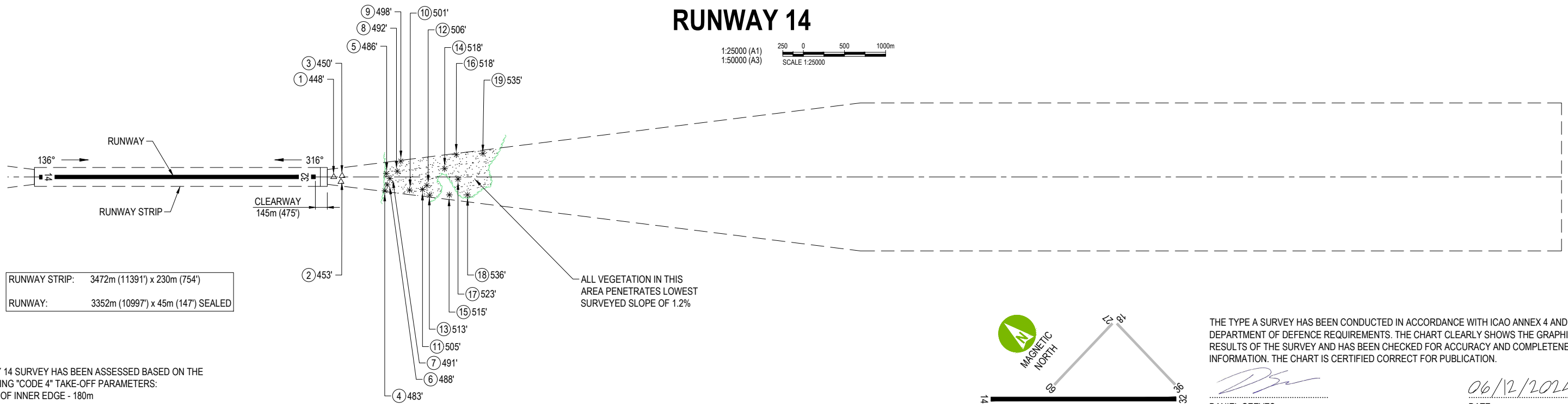

RUNWAY STRIP: 3472m (11391') x 230m (754')  
RUNWAY: 3352m (10997') x 45m (147') SEALED

RUNWAY 14 SURVEY HAS BEEN ASSESSED BASED ON THE FOLLOWING \*CODE 4\* TAKE-OFF PARAMETERS:  
LENGTH OF INNER EDGE - 180m  
RATE OF DIVERGENCE (EACH SIDE) - 12.5%  
FINAL WIDTH - 1800m  
OVERALL LENGTH - 15000m

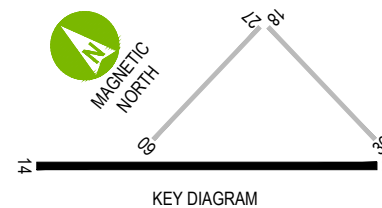

THE TYPE A SURVEY HAS BEEN CONDUCTED IN ACCORDANCE WITH ICAO ANNEX 4 AND DEPARTMENT OF DEFENCE REQUIREMENTS. THE CHART CLEARLY SHOWS THE GRAPHICAL RESULTS OF THE SURVEY AND HAS BEEN CHECKED FOR ACCURACY AND COMPLETENESS OF INFORMATION. THE CHART IS CERTIFIED CORRECT FOR PUBLICATION.

*[Signature]*  
DANIEL GEEVES  
REGISTERED SURVEYOR  
aurecon

06/12/2024  
DATE



www.aurecongroup.com



REV	DATE	REVISION DETAILS	APPROVED
A	08.10.24	FOR REVIEW	DG
B	25.10.24	FOR ISSUE	DG
C	06.12.24	FOR ISSUE - RWS WIDTH AMENDMENT	DG

SCALE	SIZE
AS SHOWN	A1/A3
<b>DRAWN</b>	
MH	
<b>SURVEYED</b>	
KI/AD/WOOLPERT	
<b>CHECKED</b>	
GH	

FOR ISSUE	NOT FOR CONSTRUCTION
<b>APPROVED</b>	
<i>[Signature]</i>	
DATE	06/12/2024
DANIEL GEEVES	

PROJECT	TITLE	DRAWING No.	PROJECT No.	WBS	TYPE	DISC	SITE	NUMBER	REV
OBSTACLE LIMITATION SURVEYS AND ASSESSMENT RAAF BASE TINDAL	AERODROME OBSTACLE CHART ICAO TYPE A (OPERATING LIMITATIONS) ISSUED DECEMBER 2024 RUNWAY 14 - SHEET 1 OF 9	520002	EST09759	DRG	UU	TDL	002	C	

**LEGEND**

- LOWEST SURVEYED SLOPE
- GROUND LEVEL
- - - - MOST LIMITING OBSTACLE
- ① OBSTACLE

DECLARED DISTANCES FOR RUNWAY 32	
TAKE OFF RUN AVAILABLE (TORA)	3352m (10997')
TAKE OFF DISTANCE AVAILABLE (TODA)	3412m (11194') 2.70%
ACCELERATE STOP DISTANCE AVAILABLE (ASDA)	3352m (10997')
LANDING DISTANCE AVAILABLE (LDA)	3352m (10997')
SUPPLEMENTARY TAKE OFF DISTANCE AVAILABLE (STODA)	3155m (10351') 1.6%, 3255m (10679') 1.9%, 3282m (10767') 2.0%, 3328m (10918') 2.2%, 3385m (11105') 2.5%

**NOTES**

- AZIMUTH AND COORDINATES FOR THIS SURVEY ARE BASED ON MGA (GDA2020) ZONE 53 THE VERTICAL DATUM BEING AHD.
- HORIZONTAL DIMENSIONS IN METRES (FEET) ELEVATIONS IN FEET
- USERS OF THIS CHART SHOULD NOTIFY ANY ERRORS OR OMISSIONS AS SOON AS THEY BECOME APPARENT TO :-  
  
AERONAUTICAL INFORMATION SERVICE - AIR FORCE  
EMAIL: AIS.AF@DEFENCE.GOV.AU
- FOR FURTHER INFORMATION REGARDING THIS CHART CONTACT THE ABOVE
- MAGNETIC VARIATION 2° 46' E (JULY 2024)
- AERIAL SURVEY COMPLETED OCTOBER 2023.  
GROUND SURVEY CHECKS AND VERIFICATION MAY 2024.

**LEGEND**

- OBSTRUCTIONS AND OBSTACLES**
- ① OBJECT NUMBER
  - 392' TOP ELEVATION IN FEET
  - TREE(S) OR VEGETATION
  - BUILDING OR LARGE STRUCTURE
  - POLE, TOWER, SPIRE ETC
  - △ ANTENNA
  - MOVING (ROADS, RAILWAY TRACKS ETC)
  - TERRAIN PENETRATING LOWEST SURVEYED SLOPE
  - OVERHEAD TRANSMISSION LINE
  - FENCE LINE
  - - - FOREST AREAS PENETRATING LOWEST SURVEYED SLOPE

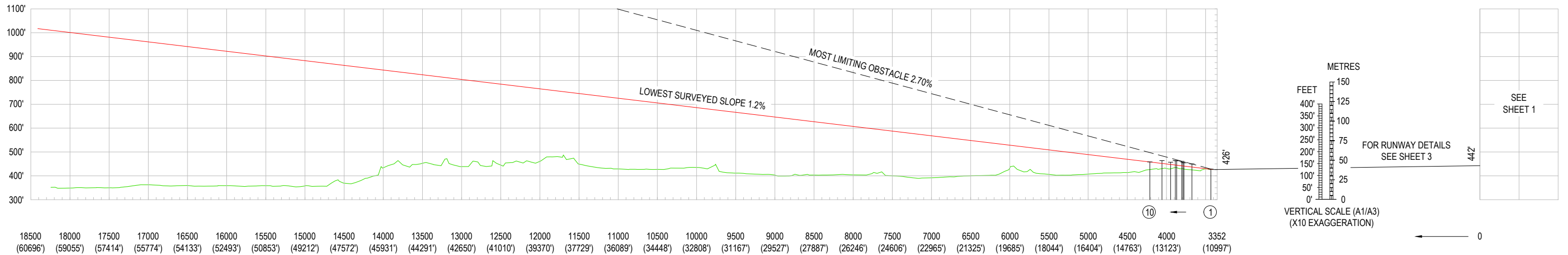

**RUNWAY 32**

1:25000 (A1)  
1:50000 (A3)  
SCALE 1:25000

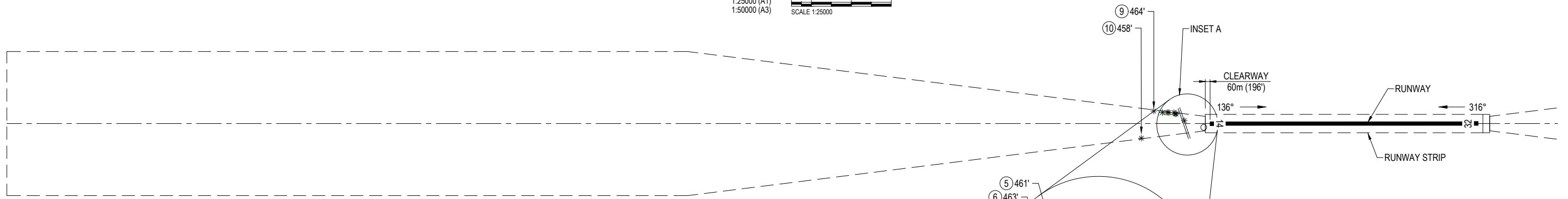

RUNWAY STRIP: 3472m (11391') x 230m (754')  
 RUNWAY: 3352m (10997') x 45m (147') SEALED

RUNWAY 32 SURVEY HAS BEEN ASSESSED BASED ON THE FOLLOWING "CODE 4" TAKE-OFF PARAMETERS:  
 LENGTH OF INNER EDGE - 180m  
 RATE OF DIVERGENCE (EACH SIDE) - 12.5%  
 FINAL WIDTH - 1800m  
 OVERALL LENGTH - 15000m

THE TYPE A SURVEY HAS BEEN CONDUCTED IN ACCORDANCE WITH ICAO ANNEX 4 AND DEPARTMENT OF DEFENCE REQUIREMENTS. THE CHART CLEARLY SHOWS THE GRAPHICAL RESULTS OF THE SURVEY AND HAS BEEN CHECKED FOR ACCURACY AND COMPLETENESS OF INFORMATION. THE CHART IS CERTIFIED CORRECT FOR PUBLICATION.

*Daniel Geeves*  
 DANIEL GEEVES  
 REGISTERED SURVEYOR  
 aurecon  
 06/12/2024  
 DATE

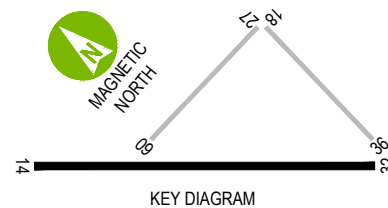

**INSET A**

1:7500 (A1)  
1:15000 (A3)  
ALL VEGETATION IN THIS AREA PENETRATES LOWEST SURVEYED SLOPE OF 1.2%



CLIENT

Australian Government  
 Department of Defence  
 Security and Estate Group

REV	DATE	REVISION DETAILS	APPROVED
A	08.10.24	FOR REVIEW	DG
B	25.10.24	FOR ISSUE	DG
C	06.12.24	FOR ISSUE - RWS WIDTH AMENDMENT	DG

SCALE	SIZE
AS SHOWN	A1/A3
<b>DRAWN</b>	
MH	
<b>SURVEYED</b>	
KI/AD/WOOLPERT	
<b>CHECKED</b>	
GH	

FOR ISSUE  
NOT FOR CONSTRUCTION

**APPROVED**

*Daniel Geeves*  
 DANIEL GEEVES  
 DATE 06/12/2024

PROJECT	TITLE	DRAWING No.	PROJECT No.	WBS	TYPE	DISC	SITE	NUMBER	REV
OBSTACLE LIMITATION SURVEYS AND ASSESSMENT RAAF BASE TINDAL	AERODROME OBSTACLE CHART ICAO TYPE A (OPERATING LIMITATIONS) ISSUED DECEMBER 2024 RUNWAY 32 - SHEET 2 OF 9	520002	EST09759	DRG	UU	TDL	003	C	

AERODROME OBSTACLE CHART - ICAO TYPE A  
(OPERATING LIMITATIONS) DECEMBER 2024, COMPILED BY  
AURECON

TO BE READ IN CONJUNCTION WITH CURRENT NOTAMS

THE ORIGIN OF THE TAKE OFF SURFACE IS LOCATED AT THE END OF THE CLEARWAY  
DISTANCES COMMENCE FROM THE START OF THE TAKE-OFF RUNWAY (SOT)

DATUM

AZIMUTH AND COORDINATES FOR THIS SURVEY ARE BASED ON MGA (GDA2020) ZONE 53  
THE VERTICAL DATUM BEING AHD.

DEFINITIONS

- RE-PSM: RUNWAY END PERMANENT SURVEY MARK
- LENGTH OF INNER EDGE 180m
- RATE OF DIVERGENCE OF SPLAY (EACH SIDE) 12.5%
- FINAL WIDTH 1800m
- OVERALL LENGTH 15000m

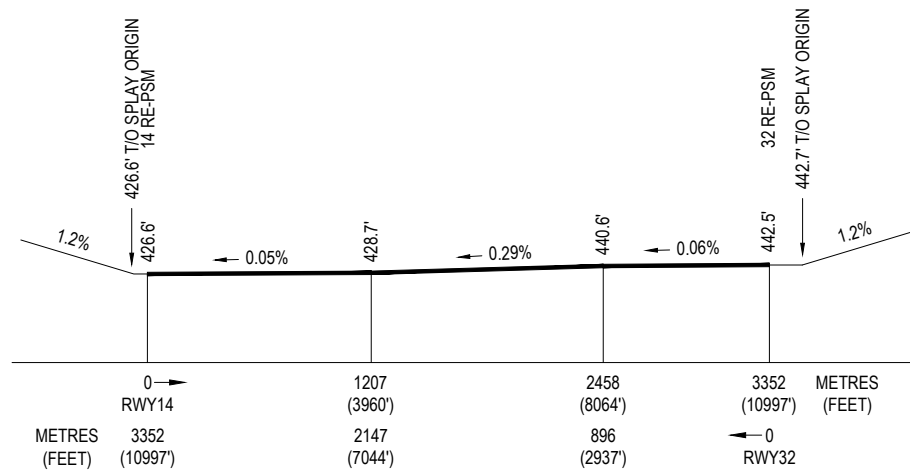

14/32 RWY LONGITUDINAL SECTION  
NOT TO SCALE

RWY 14 TAKE OFF																					
REPSM AT START OF TORA (REPSM 14)												RUNWAY MAGNETIC BEARING			TORA		TODA		ELEVATION AT T.O. ORIGIN		
GEOGRAPHIC								MGA		ELEVATION		(DEG)	(MIN)	(SEC)	(m)	(Ft)	(m)	(Ft)	(m)	(Ft)	
LAT				LONG				EASTING	NORTHING	(m)	(Ft)										
DECIMAL DEG	(DEG)	(MIN)	(SEC)	DECIMAL DEG	(DEG)	(MIN)	(SEC)														
	-14.5080306	-14°	30'	28.91"	132.3651489	132°	21'	54.536"	216008.45	8394450.15	130.0	426.6	136°	08'	26"	3352	10997	3497	11473	134.9	442.7

OBJECTS THAT APPEAR ON THE CHART																				
REF No	GEOGRAPHIC								MGA		ELEVATION TOP		TYPE OF OBSTACLE	DISTANCE FROM SOT		OFFSET			GRADIENT TO TOP	
	LAT				LONG				EASTING	NORTHING	(m)	(Ft)		(m)	(Ft)	(m)	(Ft)	LEFT/RIGHT		%
	DECIMAL DEG	(DEG)	(MIN)	(SEC)	DECIMAL DEG	(DEG)	(MIN)	(SEC)												
1	-14.532384	-14°	31"	56.58"	132.386956	132°	23"	13.04"	218391.19	8391781.19	136.4	447.5	ANTENNA	3575.7	11731.4	0.1	0.2	L	1.87	
2	-14.533325	-14°	31"	59.96"	132.387086	132°	23"	13.50"	218406.37	8391677.22	138.1	453.2	ANTENNA	3663.3	12018.8	57.8	189.7	R	1.93	
3	-14.532995	-14°	31"	58.78"	132.387665	132°	23"	15.59"	218468.40	8391714.42	137.3	450.4	LOCALISER	3676.9	12063.3	13.2	43.2	L	1.31	
4	-14.537617	-14°	32"	15.42"	132.389572	132°	23"	22.46"	218679.93	8391205.13	147.2	483.0	TREES	4197.4	13770.9	168.1	551.5	R	1.75	
5	-14.536489	-14°	32"	11.36"	132.391134	132°	23"	28.08"	218846.93	8391331.90	148.1	485.8	TREES	4214.0	13825.5	40.8	133.8	L	1.83	
6	-14.537377	-14°	32"	14.55"	132.390240	132°	23"	24.86"	218751.61	8391232.54	148.7	488.0	TREES	4224.6	13860.4	96.4	316.3	R	1.90	
7	-14.537144	-14°	32"	13.71"	132.390970	132°	23"	27.49"	218830.00	8391259.25	149.5	490.5	TREES	4256.9	13966.2	20.2	66.2	R	1.92	
8	-14.537229	-14°	32"	14.02"	132.392139	132°	23"	31.69"	218956.17	8391251.27	149.8	491.5	TREES	4346.8	14261.3	68.6	225.0	L	1.75	
9	-14.536781	-14°	32"	12.41"	132.393267	132°	23"	35.76"	219077.26	8391302.28	151.9	498.4	TREES	4389.4	14400.9	192.8	632.6	L	1.90	
10	-14.539600	-14°	32"	22.56"	132.391456	132°	23"	29.24"	218885.56	8390987.91	152.7	500.9	TREES	4496.2	14751.3	159.4	522.8	R	1.78	
11	-14.540635	-14°	32"	26.28"	132.392472	132°	23"	32.90"	218996.46	8390874.57	153.9	505.1	TREES	4654.5	15270.7	152.1	499.1	R	1.64	
12	-14.540699	-14°	32"	26.51"	132.393134	132°	23"	35.28"	219067.97	8390868.37	154.2	505.8	TREES	4706.7	15441.3	103.0	337.8	R	1.59	
13	-14.541631	-14°	32"	29.87"	132.392504	132°	23"	33.01"	219001.12	8390764.44	156.5	513.4	TREES	4739.7	15550.2	221.9	728.1	R	1.73	
14	-14.540956	-14°	32"	27.44"	132.395863	132°	23"	45.10"	219362.46	8390843.26	157.8	517.6	TREES	4921.4	16146.4	99.9	327.8	L	1.60	
15	-14.543242	-14°	32"	35.67"	132.393995	132°	23"	38.38"	219163.90	8390587.89	157.0	515.0	TREES	4979.7	16337.5	218.1	715.5	R	1.49	
16	-14.540911	-14°	32"	27.27"	132.397922	132°	23"	52.51"	219584.42	8390850.80	157.9	518.0	TREES	5063.5	16612.7	270.4	887.2	L	1.47	
17	-14.542818	-14°	32"	34.14"	132.395971	132°	23"	45.49"	219376.44	8390637.24	159.4	522.8	TREES	5084.3	16680.9	26.8	87.8	R	1.54	
18	-14.544745	-14°	32"	41.08"	132.395343	132°	23"	43.23"	219311.21	8390423.19	163.4	536.0	TREES	5200.5	17062.0	217.9	714.8	R	1.67	
19	-14.543025	-14°	32"	34.89"	132.400004	132°	24"	00.01"	219811.63	8390619.30	162.9	534.6	TREES	5387.4	17675.1	285.7	937.5	L	1.48	

RWY 32 TAKE OFF																					
REPSM AT START OF TORA (REPSM 32)												RUNWAY MAGNETIC BEARING			TORA		TODA		ELEVATION AT T.O. ORIGIN		
GEOGRAPHIC								MGA		ELEVATION		(DEG)	(MIN)	(SEC)	(m)	(Ft)	(m)	(Ft)	(m)	(Ft)	
LAT				LONG				EASTING	NORTHING	(m)	(Ft)										
DECIMAL DEG	(DEG)	(MIN)	(SEC)	DECIMAL DEG	(DEG)	(MIN)	(SEC)														
	-14.5308625	-14°	31'	51.105"	132.3855929	132°	23'	08.135"	218242.25	8391947.95	134.9	442.5	316°	08'	26"	3352	10997	3412	11194	130.0	426.6

OBJECTS THAT APPEAR ON THE CHART																				
REF No	GEOGRAPHIC								MGA		ELEVATION TOP		TYPE OF OBSTACLE	DISTANCE FROM SOT		OFFSET			GRADIENT TO TOP	
	LAT				LONG				EASTING	NORTHING	(m)	(Ft)		(m)	(Ft)	(m)	(Ft)	LEFT/RIGHT		%
	DECIMAL DEG	(DEG)	(MIN)	(SEC)	DECIMAL DEG	(DEG)	(MIN)	(SEC)												
1	-14.507765	-14°	30"	27.95"	132.364333	132°	21"	51.59"	215920.10	8394478.54	130.5	428.0	BOLLARD	3432.2	11260.6	47.0	154.1	L	2.16	
2	-14.505618	-14°	30"	20.22"	132.363439	132°	21"	48.37"	215820.91	8394715.07	137.1	449.8	TREE	3674.6	12055.7	36.5	119.8	R	2.70	
3	-14.504428	-14°	30"	15.93"	132.363408	132°	21"	48.26"	215816.09	8394846.83	138.5	454.3	TREES	3776.0	12388.6	120.6	395.7	R	2.32	
4	-14.504333	-14°	30"	15.59"	132.363337	132°	21"	48.01"	215808.33	8394857.28	139.5	457.5	TREES	3789.0	12431.1	121.8	399.5	R	2.50	
5	-14.504132	-14°	30"	14.87"	132.363358	132°	21"	48.08"	215810.31	8394879.49	140.5	461.0	TREES	3804.2	12481.1	138.0	452.9	R	2.67	
6	-14.503693	-14°	30"	13.29"	132.362967	132°	21"	46.68"	215767.57	8394927.63	141.1	463.0	TREES	3868.6	12692.1	138.2	453.4	R	2.43	
7	-14.503561	-14°	30"	12.81"	132.362874	132°	21"	46.34"	215757.43	8394942.12	141.5	464.3	TREES	3886.1	12749.8	140.3	460.3	R	2.42	
8	-14.503158	-14°	30"	11.36"	132.362486	132°	21"	44.94"	215714.98	8394986.26	139.3	457.1	TREES	3947.3	12950.4	138.0	452.8	R	1.74	
9	-14.502306	-14°	30"	08.30"	132.361942	132°	21"	42.99"	215655.31	8395079.93	141.4	463.8	TREES	4056.8	13309.8	155.9	511.4	R	1.76	
10	-14.503261	-14°	30"	11.73"	132.358636	132°	21"	31.08"	215299.91	8394970.05	139.7	458.2	TREE	4211.5	13817.1	182.2	597.8	L	1.21	

THE TYPE A SURVEY HAS BEEN CONDUCTED IN ACCORDANCE WITH ICAO ANNEX 4 AND DEPARTMENT OF DEFENCE REQUIREMENTS. THE CHART CLEARLY SHOWS THE GRAPHICAL RESULTS OF THE SURVEY AND HAS BEEN CHECKED FOR ACCURACY AND COMPLETENESS OF INFORMATION. THE CHART IS CERTIFIED CORRECT FOR PUBLICATION.

DANIEL GEEVES  
REGISTERED SURVEYOR  
aurecon

06/12/2024  
DATE



www.aurecongroup.com

CLIENT



REV	DATE	REVISION DETAILS	APPROVED
A	08.10.24	FOR REVIEW	DG
B	25.10.24	FOR ISSUE	DG
C	06.12.24	FOR ISSUE - RWS WIDTH AMENDMENT	DG

SCALE	SIZE
AS SHOWN	A1/A3
DRAWN	MH
SURVEYED	KI/AD/WOOLPERT
CHECKED	GH

FOR ISSUE	NOT FOR CONSTRUCTION
APPROVED	DATE 06/12/2024
	DANIEL GEEVES

PROJECT	TITLE	DRAWING No.	PROJECT No.	WBS	TYPE	DISC	SITE	NUMBER	REV
OBSTACLE LIMITATION SURVEYS AND ASSESSMENT RAAF BASE TINDAL	AERODROME OBSTACLE CHART ICAO TYPE A (OPERATING LIMITATIONS) ISSUED DECEMBER 2024 RUNWAY 14/32 - SHEET 3 OF 9	520002	EST09759	DRG	UU	TDL	004	C	





AERODROME OBSTACLE CHART - ICAO TYPE A  
(OPERATING LIMITATIONS) DECEMBER 2024, COMPILED BY  
AURECON

TO BE READ IN CONJUNCTION WITH CURRENT NOTAMS

THE ORIGIN OF THE TAKE OFF SURFACE IS LOCATED AT THE END OF THE CLEARWAY  
DISTANCES COMMENCE FROM THE START OF THE TAKE-OFF RUNWAY (SOT)

DATUM

AZIMUTH AND COORDINATES FOR THIS SURVEY ARE BASED ON MGA (GDA2020) ZONE 53  
THE VERTICAL DATUM BEING AHD.

DEFINITIONS

- RE-PSM: RUNWAY END PERMANENT SURVEY MARK
- LENGTH OF INNER EDGE 80m
- RATE OF DIVERGENCE OF SPLAY (EACH SIDE) 10%
- FINAL WIDTH 580m
- OVERALL LENGTH 2500m

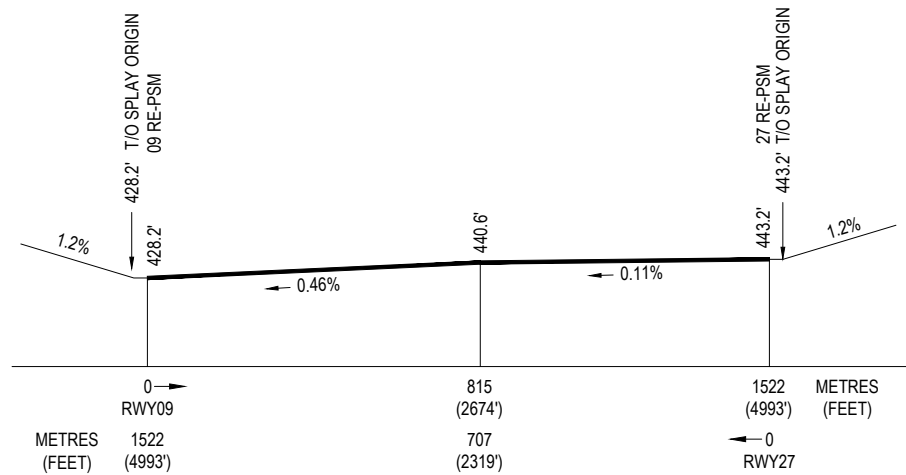

09/27 RWY LONGITUDINAL SECTION  
NOT TO SCALE

RWY 09 TAKE OFF																					
REPSM AT START OF TORA (REPSM 09)													RUNWAY MAGNETIC BEARING			TORA		TODA		ELEVATION AT T.O. ORIGIN	
REF No	GEOGRAPHIC								MGA		ELEVATION		(DEG)	(MIN)	(SEC)	(m)	(Ft)	(m)	(Ft)		
	LAT				LONG				EASTING	NORTHING	(m)	(Ft)									
	DECIMAL DEG	(DEG)	(MIN)	(SEC)	DECIMAL DEG	(DEG)	(MIN)	(SEC)													
	-14.5142960	-14°	30'	51.466"	132.3739912	132°	22'	26.369"	216970.06	8393767.53	130.5	428.2	89°	38'	40"	1522	4993	1582	5190	135.1	443.2
OBJECTS THAT APPEAR ON THE CHART																					
REF No	GEOGRAPHIC								MGA		ELEVATION TOP		TYPE OF OBSTACLE	DISTANCE FROM SOT		OFFSET			GRADIENT TO TOP		
	LAT				LONG				EASTING	NORTHING	(m)	(Ft)		(m)	(Ft)	(m)	(Ft)	LEFT/RIGHT		%	
	DECIMAL DEG	(DEG)	(MIN)	(SEC)	DECIMAL DEG	(DEG)	(MIN)	(SEC)													
1	-14.515195	-14°	30"	54.70"	132.388318	132°	23"	17.94"	218516.27	8393685.78	138.6	454.9	MOVING	1486.1	4875.8	33.7	110.6	R	-		
2	-14.514856	-14°	30"	53.48"	132.388701	132°	23"	19.32"	218557.14	8393723.69	139.3	457.1	MOVING	1589.4	5214.4	4.6	15.0	R	112.18		
3	-14.514562	-14°	30"	52.42"	132.389420	132°	23"	21.91"	218634.28	8393757.10	136.0	446.4	FENCE	1662.8	5455.3	40.3	132.2	L	1.21		
4	-14.514559	-14°	30"	52.41"	132.389470	132°	23"	22.09"	218639.66	8393757.56	138.1	453.0	MOVING	1668.1	5472.9	40.9	134.3	L	3.50		
5	-14.515260	-14°	30"	54.93"	132.389708	132°	23"	22.94"	218666.24	8393680.21	141.3	463.7	TREES	1697.1	5567.8	35.5	116.6	R	5.49		
6	-14.514483	-14°	30"	52.13"	132.390460	132°	23"	25.65"	218746.33	8393767.22	144.7	474.6	TREES	1774.4	5821.6	53.8	176.6	L	5.00		
7	-14.515336	-14°	30"	55.20"	132.390513	132°	23"	25.84"	218753.13	8393672.87	144.9	475.4	TREES	1784.1	5853.3	40.2	131.9	R	4.89		
8	-14.515534	-14°	30"	55.92"	132.391335	132°	23"	28.80"	218842.01	8393651.90	146.3	480.1	TREES	1873.5	6146.7	58.4	191.8	R	3.87		
9	-14.515588	-14°	30"	56.11"	132.392099	132°	23"	31.55"	218924.47	8393646.86	146.6	480.9	TREES	1956.0	6417.4	61.0	200.1	R	3.08		
10	-14.515616	-14°	30"	56.21"	132.392249	132°	23"	32.09"	218940.75	8393643.95	147.5	483.8	TREES	1972.4	6471.1	63.4	207.9	R	3.18		
11	-14.514334	-14°	30"	51.60"	132.392496	132°	23"	32.98"	218965.76	8393786.23	147.6	484.2	TREES	1993.0	6538.8	79.5	260.9	L	3.05		
12	-14.514304	-14°	30"	51.49"	132.393067	132°	23"	35.03"	219027.24	8393790.17	148.0	485.4	TREES	2054.3	6739.9	85.3	279.9	L	2.73		
13	-14.515153	-14°	30"	54.55"	132.393399	132°	23"	36.23"	219064.14	8393696.63	148.4	486.8	TREES	2094.0	6870.2	7.0	23.0	R	2.60		
14	-14.514352	-14°	30"	51.66"	132.393607	132°	23"	36.98"	219085.58	8393785.51	149.2	489.6	TREES	2112.8	6931.6	82.4	270.5	L	2.67		
15	-14.515434	-14°	30"	55.56"	132.393721	132°	23"	37.39"	219099.29	8393665.87	150.1	492.4	TREES	2130.1	6988.5	36.7	120.3	R	2.74		
16	-14.515993	-14°	30"	57.57"	132.394270	132°	23"	39.37"	219159.21	8393604.75	154.0	505.3	TREES	2191.8	7191.0	95.9	314.6	R	3.11		
17	-14.515919	-14°	30"	57.30"	132.395185	132°	23"	42.66"	219257.79	8393614.02	154.8	508.0	TREES	2290.0	7513.2	83.6	274.3	R	2.79		
18	-14.514183	-14°	30"	51.05"	132.396158	132°	23"	46.17"	219360.53	8393807.40	156.8	514.5	TERRAIN/TREES	2386.7	7830.5	112.7	369.7	L	2.70		
19	-14.516199	-14°	30"	58.31"	132.396248	132°	23"	46.49"	219372.73	8393584.38	146.5	480.6	MOVING	2405.7	7892.8	109.7	360.0	R	1.39		
20	-14.514089	-14°	30"	50.72"	132.396821	132°	23"	48.55"	219431.90	8393818.62	159.3	522.7	TREES	2457.7	8063.3	126.1	413.6	L	2.77		
21	-14.514484	-14°	30"	52.14"	132.398303	132°	23"	53.89"	219592.23	8393776.75	162.1	531.9	TREES	2619.1	8593.0	89.1	292.4	L	2.61		
22	-14.514231	-14°	30"	51.23"	132.398507	132°	23"	54.62"	219613.89	8393805.02	163.8	537.6	TREES	2639.9	8661.1	118.0	387.3	L	2.72		
23	-14.514080	-14°	30"	50.68"	132.399378	132°	23"	57.76"	219707.61	8393822.78	166.6	546.6	TERRAIN/TREES	2733.0	8966.5	138.6	454.8	L	2.74		
24	-14.515450	-14°	30"	55.62"	132.399725	132°	23"	59.00"	219746.77	8393671.48	162.3	532.5	TREES	2776.7	9110.0	11.3	37.1	R	2.28		
25	-14.513826	-14°	30"	49.77"	132.401462	132°	24"	05.26"	219932.09	8393853.47	156.3	512.6	MOVING	2956.3	9699.1	176.1	577.9	L	1.54		
26	-14.514258	-14°	30"	51.32"	132.401555	132°	24"	05.59"	219942.67	8393805.77	153.2	502.7	FENCE	2968.3	9738.6	128.8	422.6	L	1.31		
27	-14.515362	-14°	30"	55.30"	132.407351	132°	24"	26.46"	220569.02	8393690.66	165.7	543.6	TREES	3597.5	11802.9	32.9	108.0	L	1.52		
28	-14.517866	-14°	31"	04.31"	132.410937	132°	24"	39.37"	220958.97	8393417.79	166.4	546.0	TREES	3995.4	13108.2	227.8	747.3	R	1.30		

RWY 27 TAKE OFF																					
REPSM AT START OF TORA (REPSM 27)													RUNWAY MAGNETIC BEARING			TORA		TODA		ELEVATION AT T.O. ORIGIN	
REF No	GEOGRAPHIC								MGA		ELEVATION		(DEG)	(MIN)	(SEC)	(m)	(Ft)	(m)	(Ft)		
	LAT				LONG				EASTING	NORTHING	(m)	(Ft)									
	DECIMAL DEG	(DEG)	(MIN)	(SEC)	DECIMAL DEG	(DEG)	(MIN)	(SEC)													
	-14.5148735	-14°	30'	53.547"	132.3881079	132°	23'	17.189"	218493.21	8393721.06	135.1	443.2	269°	38'	41"	1522	4993	1582	5190	130.5	428.2
OBJECTS THAT APPEAR ON THE CHART																					
REF No	GEOGRAPHIC								MGA		ELEVATION TOP		TYPE OF OBSTACLE	DISTANCE FROM SOT		OFFSET			GRADIENT TO TOP		
	LAT				LONG				EASTING	NORTHING	(m)	(Ft)		(m)	(Ft)	(m)	(Ft)	LEFT/RIGHT		%	
	DECIMAL DEG	(DEG)	(MIN)	(SEC)	DECIMAL DEG	(DEG)	(MIN)	(SEC)													
1	-14.513934	-14°	30"	50.16"	132.368219	132°	22"	05.58"	216347.08	8393800.44	137.7	451.7	WINDSOCK	2146.3	7041.6	13.9	45.6	R	1.27		
2	-14.512777	-14°	30"	45.99"	132.365244	132°	21"	54.87"	216024.77	8393924.79	158.9	521.2	TREE	2472.0	8110.4	128.3	420.9	R	3.19		
3	-14.513074	-14°	30"	47.06"	132.365137	132°	21"	54.49"	216013.59	8393891.84	151.0	495.4	LIGHT POLE	2482.2	8143.7	95.0	311.8	R	2.28		
4	-14.512988	-14°	30"	46.75"	132.363398	132°	21"	48.23"	215825.98	8393899.18	156.4	513.2	ANTENNA	2669.8	8759.4	96.6	317.1	R	2.38		

THE TYPE A SURVEY HAS BEEN CONDUCTED IN ACCORDANCE WITH ICAO ANNEX 4 AND DEPARTMENT OF DEFENCE REQUIREMENTS. THE CHART CLEARLY SHOWS THE GRAPHICAL RESULTS OF THE SURVEY AND HAS BEEN CHECKED FOR ACCURACY AND COMPLETENESS OF INFORMATION. THE CHART IS CERTIFIED CORRECT FOR PUBLICATION.

*[Signature]*  
DANIEL GEEVES  
REGISTERED SURVEYOR  
aurecon

06/12/2024  
DATE



www.aurecongroup.com



REV	DATE	REVISION DETAILS	APPROVED
A	08.10.24	FOR REVIEW	DG
B	25.10.24	FOR ISSUE	DG
C	06.12.24	FOR ISSUE - RWS WIDTH AMENDMENT	DG

SCALE	SIZE
AS SHOWN	A1/A3
DRAWN	MH
SURVEYED	KI/AD/WOOLPERT
CHECKED	GH

FOR ISSUE	NOT FOR CONSTRUCTION
APPROVED	
<i>[Signature]</i>	
DANIEL GEEVES	

PROJECT	TITLE	DRAWING No.	PROJECT No.	WBS	TYPE	DISC	SITE	NUMBER	REV
OBSTACLE LIMITATION SURVEYS AND ASSESSMENT RAAF BASE TINDAL	AERODROME OBSTACLE CHART ICAO TYPE A (OPERATING LIMITATIONS) ISSUED DECEMBER 2024 RUNWAY 09/27 - SHEET 6 OF 9	520002	EST09759	DRG	UU	TDL	007	C	





**LEGEND**

- LOWEST SURVEYED SLOPE
- GROUND LEVEL
- - - - MOST LIMITING OBSTACLE
- 1 OBSTACLE

DECLARED DISTANCES FOR EMERGENCY RUNWAY 36 (TWY S)	
TAKE OFF RUN AVAILABLE (TORA)	1522m (4993')
TAKE OFF DISTANCE AVAILABLE (TODA)	1582m (5190') REFER NOTE BELOW
ACCELERATE STOP DISTANCE AVAILABLE (ASDA)	1522m (4993')
LANDING DISTANCE AVAILABLE (LDA)	1522m (4993')
SUPPLEMENTARY TAKE OFF DISTANCE AVAILABLE (STODA)	867m (2844') 1.9%, 1032m (3385') 2.0%, 1249m (4097') 2.2%, 1313m (4307') 2.5%, 1426m (4678') 3.3%, 1468m (4816') 5.0%

NOTE:  
AN UNCONTROLLED MOVING OBJECT IS LOCATED IN THE CLEARWAY, THEREFORE THE TODA GRADIENT CANNOT BE PUBLISHED

**NOTES**

- AZIMUTH AND COORDINATES FOR THIS SURVEY ARE BASED ON MGA (GDA2020) ZONE 53 THE VERTICAL DATUM BEING AHD.
- HORIZONTAL DIMENSIONS IN METRES (FEET) ELEVATIONS IN FEET
- USERS OF THIS CHART SHOULD NOTIFY ANY ERRORS OR OMISSIONS AS SOON AS THEY BECOME APPARENT TO :-  
  
AERONAUTICAL INFORMATION SERVICE - AIR FORCE  
EMAIL: AIS.AF@DEFENCE.GOV.AU
- FOR FURTHER INFORMATION REGARDING THIS CHART CONTACT THE ABOVE
- MAGNETIC VARIATION 2° 46' E (JULY 2024)
- AERIAL SURVEY COMPLETED OCTOBER 2023.  
GROUND SURVEY CHECKS AND VERIFICATION MAY 2024.

**LEGEND**

- OBSTRUCTIONS AND OBSTACLES**
- 1 OBJECT NUMBER
  - 392' TOP ELEVATION IN FEET
  - \* TREE(S) OR VEGETATION
  - BUILDING OR LARGE STRUCTURE
  - POLE, TOWER, SPIRE ETC
  - △ ANTENNA
  - MOVING (ROADS, RAILWAY TRACKS ETC)
  - TERRAIN PENETRATING LOWEST SURVEYED SLOPE
  - OVERHEAD TRANSMISSION LINE
  - FENCE LINE
  - FOREST AREAS PENETRATING LOWEST SURVEYED SLOPE

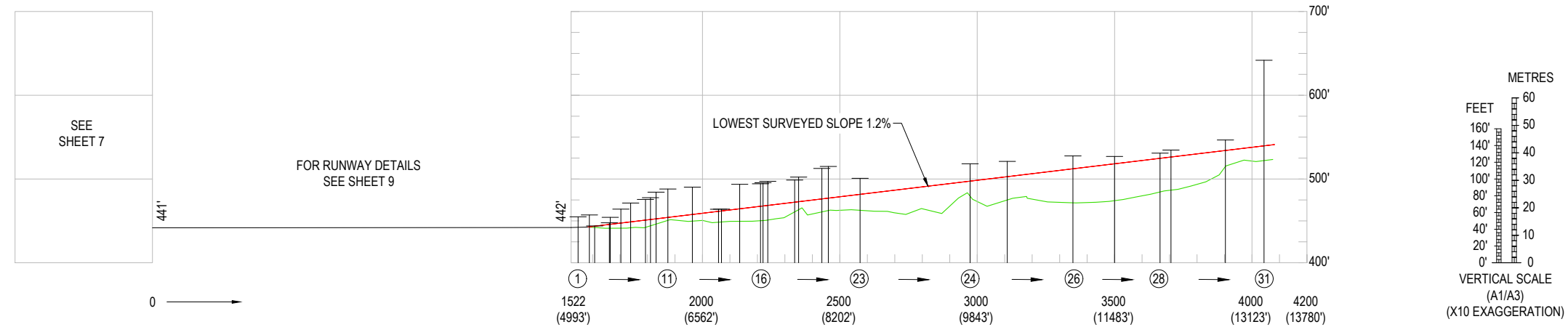

**EMERGENCY RUNWAY 36  
TWY S (CODE 2)**

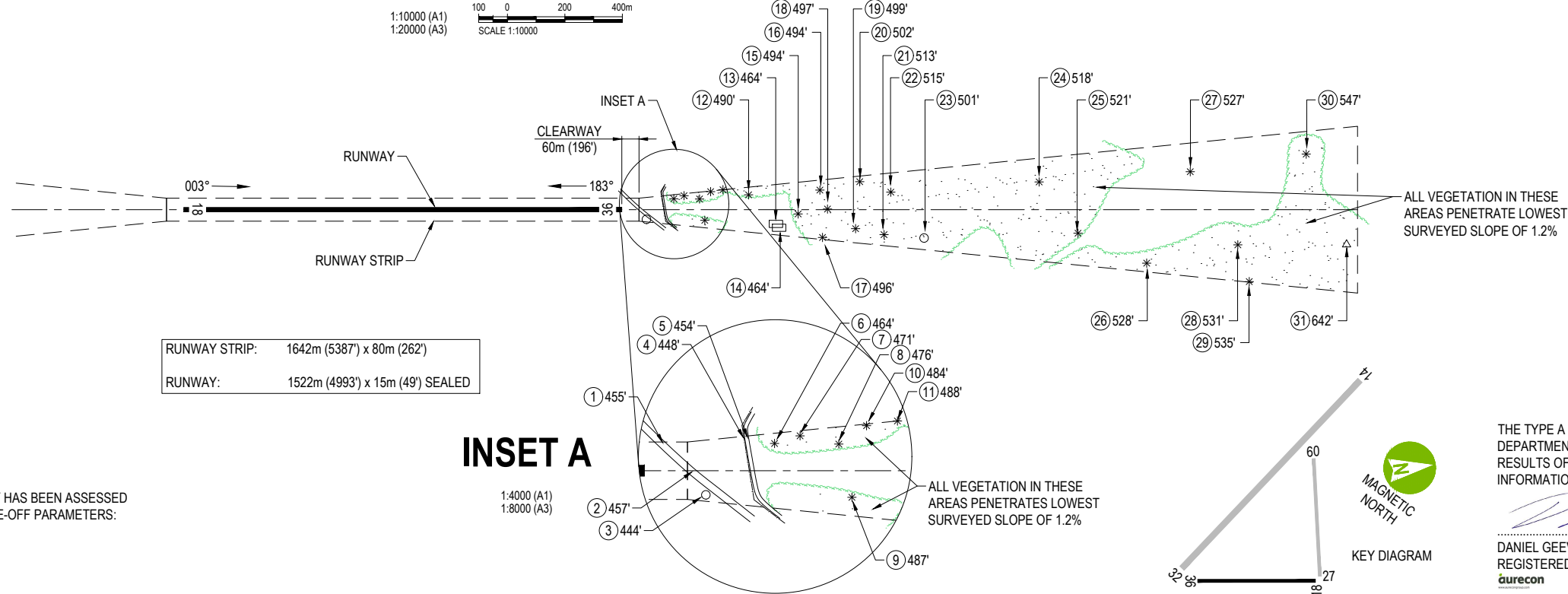

EMERGENCY RUNWAY 36 (TWY S) SURVEY HAS BEEN ASSESSED BASED ON THE FOLLOWING "CODE 2" TAKE-OFF PARAMETERS:  
LENGTH OF INNER EDGE - 80m  
RATE OF DIVERGENCE (EACH SIDE) - 10%  
FINAL WIDTH - 580m  
OVERALL LENGTH - 2500m

THE TYPE A SURVEY HAS BEEN CONDUCTED IN ACCORDANCE WITH ICAO ANNEX 4 AND DEPARTMENT OF DEFENCE REQUIREMENTS. THE CHART CLEARLY SHOWS THE GRAPHICAL RESULTS OF THE SURVEY AND HAS BEEN CHECKED FOR ACCURACY AND COMPLETENESS OF INFORMATION. THE CHART IS CERTIFIED CORRECT FOR PUBLICATION.

*[Signature]*  
DANIEL GEEVES  
REGISTERED SURVEYOR  
aurecon  
DATE: 06/12/2024



CLIENT

**Australian Government**  
Department of Defence  
Security and Estate Group

REV	DATE	REVISION DETAILS	APPROVED
A	08.10.24	FOR REVIEW	DG
B	25.10.24	FOR ISSUE	DG
C	06.12.24	FOR ISSUE - RWS WIDTH AMENDMENT	DG

SCALE	SIZE
AS SHOWN	A1/A3
<b>DRAWN</b>	
MH	
<b>SURVEYED</b>	
KI/AD/WOOLPERT	
<b>CHECKED</b>	
GH	

FOR ISSUE  
NOT FOR CONSTRUCTION

**APPROVED**

*[Signature]*  
DATE: 06/12/2024  
DANIEL GEEVES

PROJECT	TITLE	DRAWING No.	PROJECT No.	WBS	TYPE	DISC	SITE	NUMBER	REV
OBSTACLE LIMITATION SURVEYS AND ASSESSMENT RAAF BASE TINDAL	AERODROME OBSTACLE CHART ICAO TYPE A (OPERATING LIMITATIONS) ISSUED DECEMBER 2024 EMERGENCY RUNWAY 36 (TWY S) - SHEET 8 OF 9	520002	EST09759	DRG	UU	TDL	009	C	

