

RAAF BASE TINDAL, AUSTRALIA

RUNWAY 14L/32R

ICAO TYPE A (OPERATING LIMITATIONS) CHART

SHEET 1 of 2

TO BE READ IN CONJUNCTION WITH CURRENT NOTAMs

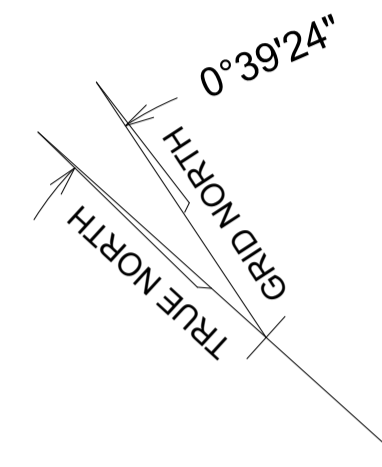
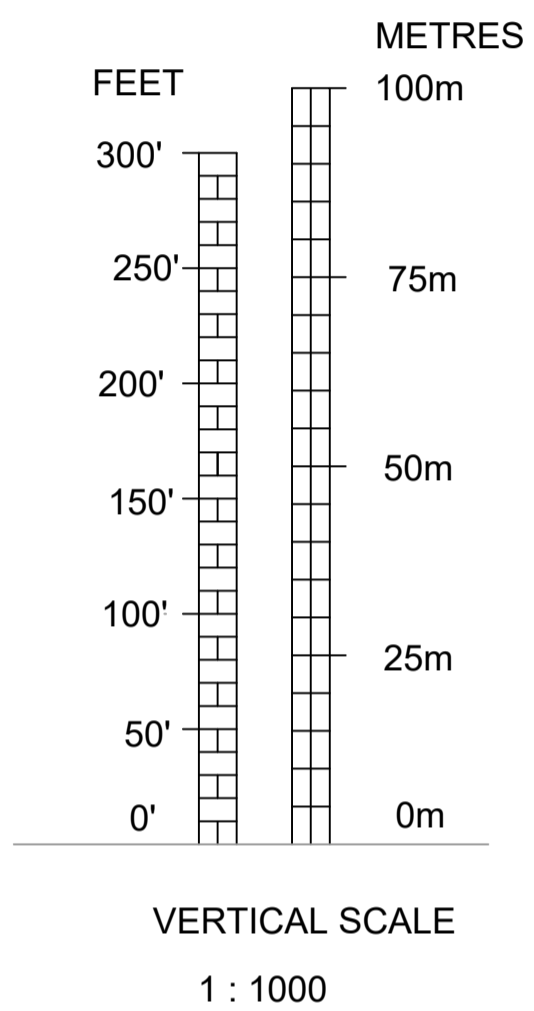
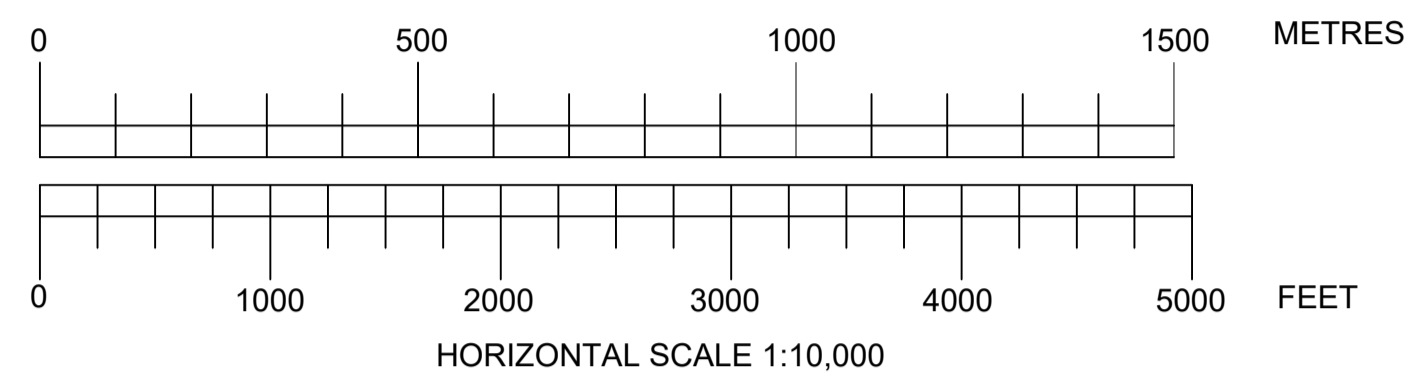

DECLARED DISTANCES FOR RWY 14L/32R		
RWY 14L		RWY 32R
3232	TAKE-OFF RUN AVAILABLE (TORA)	3232
3292	TAKE-OFF DISTANCE AVAILABLE (TODA)	3292
3232	ACCELERATE-STOP DISTANCE AVAILABLE (ASDA)	3232
3232	LANDING DISTANCE AVAILABLE (LDA)	3232

DATUMS	
VERTICAL	AUSTRALIAN HEIGHT DATUM
HORIZONTAL	GDA2020
HORIZONTAL DISTANCES ARE IN METRES.	
VERTICAL DISTANCES ARE IN FEET	
MAGNETIC DECLINATION +2.62° EPOCH JANUARY 2025	
ANNUAL VARIATION -0.05°/DEG/YR	

LEGEND	
<u>OBSTRUCTIONS & OBSTACLES</u>	
Identification number	⑤
Top elevation in feet	451'
Tree(s) or shrub(s)	✱
Building or large structure	◻
Pole, tower, spire, antenna etc.	●

DATE SURVEYED	DATE ISSUED	ISSUE No.	AMENDMENT
NOV 2025	DEC 2025	3	32R Threshold relocated, runway extended, Declared Dist Change.
APR 2025	MAY 2025	2	RWY 14L only resurveyed. RWY 14L & 32R redrafted.
JAN 2025	JAN 2025	1	Resurveyed. Various points removed and added.

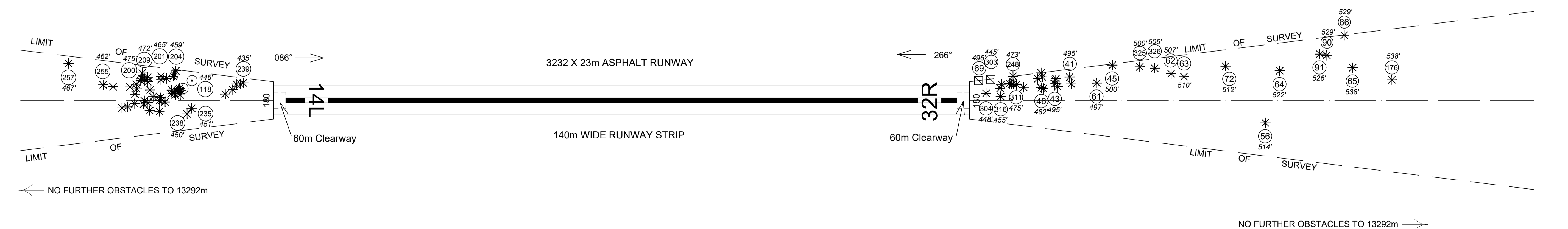

RAAF BASE TINDAL - AUSTRALIA

TYPE A OPERATING CHART - OBSTACLE DATA RWYS 14L & 32R

DATE: November 2025

Amended: April 2026

AIRPORT SURVEYS



0409 230 650
paul@airportsurveys.com.au

SHEET 2 OF 2 SHEETS

Take Off Runway	Point ID	Dist from TODA End	Dist from SOT	Offset	GDA2020		AHD Elevation (m)	AHD Elevation (ft)	Description	Take-Off Gradient	
					Latitude DD.MMSs	Longitude DDD.MMSs					
14L	69	43.8	3336.6	95.4	L	-14.314616	132.231621	151.24	496	Transient, 16.8m high	38.12%
14L	304	80.4	3373.2	34.3	L	-14.314836	132.231547	136.69	448	Bush in group	2.68%
14L	303	103.0	3395.8	100.9	L	-14.314749	132.231764	135.78	445	Chainwire Fence	1.21%
14L	305	147.5	3440.3	58.3	L	-14.314949	132.231755	138.42	454	Tree in group	2.64%
14L	316	150.9	3443.7	19.1	L	-14.315041	132.231664	138.64	455	Tree in group	2.72%
14L	306	154.1	3446.9	77.9	L	-14.314923	132.231819	139.91	459	Tree in group	3.49%
14L	308	192.2	3485.0	81.5	L	-14.315009	132.231912	140.43	461	Tree in group	3.07%
14L	309	203.1	3495.9	79.1	L	-14.315041	132.231929	140.96	462	Tree in group	3.17%
14L	248	210.0	3502.8	116.1	L	-14.314979	132.232038	144.08	473	Tree in group	4.55%
14L	310	211.3	3504.1	79.4	L	-14.315061	132.231948	142.35	467	Tree in group	3.70%
14L	311	225.9	3518.7	76.3	L	-14.315103	132.231973	144.73	475	Tree in group	4.52%
14L	317	261.7	3554.5	63.1	L	-14.315219	132.232018	143.67	471	Tree in group	3.49%
14L	249	272.5	3565.3	119.7	L	-14.315124	132.232184	145.95	479	Tree in group	4.19%
14L	314	329.2	3622.0	105.1	L	-14.315294	132.232272	147.81	485	Tree in group	4.04%
14L	244	345.5	3638.3	133.0	L	-14.315275	132.232378	150.40	493	Tree in group	4.60%
14L	46	345.8	3638.6	61.2	L	-14.315429	132.232198	147.04	482	Tree in group	3.62%
14L	40	350.7	3643.5	113.8	L	-14.315329	132.232341	149.14	489	Tree in group	4.17%
14L	321	355.8	3648.6	57.6	L	-14.315461	132.232211	148.06	486	Tree in group	3.80%
14L	43	410.9	3703.7	80.5	L	-14.315547	132.232389	150.75	495	Tree in group	3.95%
14L	42	412.8	3705.6	98.3	L	-14.315514	132.232438	149.86	492	Tree in group	3.72%
14L	300	417.0	3709.8	105.3	L	-14.315509	132.232465	148.97	489	Tree in group	3.46%
14L	47	424.7	3717.5	65.9	L	-14.315612	132.232383	149.86	492	Tree in group	3.61%
14L	41	482.6	3775.4	113.0	L	-14.315654	132.232628	150.90	495	Tree in group	3.40%
14L	44	490.8	3783.6	79.7	L	-14.315745	132.232563	150.77	495	Tree in group	3.31%
14L	61	613.1	3905.9	83.6	L	-14.320037	132.232841	151.37	497	Tree in group	2.75%
14L	45	688.3	3981.1	170.2	L	-14.320036	132.233224	152.28	500	Tree in group	2.58%
14L	325	820.3	4113.1	162.1	L	-14.320377	132.233494	152.37	500	Tree in group	2.18%
14L	326	892.4	4185.2	155.1	L	-14.320568	132.233634	154.37	506	Tree in group	2.23%
14L	62	971.5	4264.3	129.2	L	-14.320818	132.233743	154.49	507	Tree in group	2.06%
14L	63	1033.4	4326.2	114.7	L	-14.321001	132.233842	155.42	510	Tree in group	2.02%
14L	72	1233.7	4526.5	165.3	L	-14.321384	132.234409	155.99	512	Tree in group	1.74%
14L	56	1425.6	4718.4	108.2	R	-14.322439	132.234142	156.56	514	Tree in group	1.55%
14L	64	1494.6	4787.4	142.9	L	-14.322071	132.234926	159.10	522	Tree in group	1.65%
14L	91	1687.2	4980.0	223.5	L	-14.322371	132.235552	160.20	526	Tree in group	1.53%
14L	90	1721.7	5014.5	217.1	L	-14.322469	132.235611	161.23	529	Tree in group	1.56%
14L	86	1805.1	5097.9	314.0	L	-14.322466	132.240038	161.26	529	Tree in group	1.49%
14L	65	1845.9	5138.7	157.8	L	-14.322900	132.235735	164.06	538	Tree in group	1.60%
14L	176	2035.0	5327.8	99.7	L	-14.323489	132.240004	164.06	538	Tree in group	1.46%
Coordinates of Take Splay Origins:						RWY 14L	-14.314712	132.231284	134.54		
						RWY 32R	-14.302492	132.215924	129.95		

Take Off Runway	Point ID	Dist from TODA End	Dist from SOT	Offset	GDA2020		AHD Elevation (m)	AHD Elevation (ft)	Description	Take-Off Gradient	
					Latitude DD.MMSSss	Longitude DDD.MMSSss					
32R	239	144.7	3437.5	84.2	R	-14.301957	132.215818	132.67	435	Tree in group	1.88%
32R	240	158.2	3451.0	79.2	R	-14.301934	132.215776	133.26	437	Tree in group	2.10%
32R	241	178.5	3471.3	79.1	R	-14.301885	132.215731	133.41	438	Tree in group	1.94%
32R	242	195.5	3488.3	51.8	R	-14.301902	132.215625	133.86	439	Tree in group	2.01%
32R	258	231.9	3524.7	30.7	R	-14.301858	132.215492	133.36	438	Tree in group	1.47%
32R	118	391.8	3684.6	95.8	R	-14.301326	132.215305	135.98	446	Tree in group	1.54%
32R	235	393.6	3686.4	37.8	L	-14.301607	132.214965	137.35	451	Tree in group	1.88%
32R	238	416.0	3708.8	64.7	L	-14.301610	132.214848	137.02	450	Tree in group	1.70%
32R	120	435.2	3728.0	57.5	R	-14.301302	132.215113	138.39	454	Tree in group	1.95%
32R	218	447.1	3739.9	47.1	R	-14.301295	132.215061	138.74	455	Tree in group	1.97%
32R	223	449.0	3741.8	26.6	R	-14.301334	132.215005	138.56	455	Tree in group	1.92%
32R	215	452.5	3745.3	58.4	R	-14.301257	132.215077	140.19	460	Tree in group	2.27%
32R	217	457.0	3749.8	52.0	R	-14.301260	132.215051	138.92	456	Tree in group	1.97%
32R	220	459.9	3752.7	43.0	R	-14.301272	132.215023	139.93	459	Tree in group	2.18%
32R	204	469.9	3762.7	142.4	R	-14.301035	132.215251	140.01	459	Tree in group	2.15%
32R	224	472.3	3765.1	26.4	R	-14.301277	132.214953	138.54	455	Tree in group	1.82%
32R	201	476.1	3768.9	122.7	R	-14.301062	132.215187	141.81	465	Tree in group	2.50%
32R	221	477.7	3770.5	35.2	R	-14.301245	132.214964	140.80	462	Tree in group	2.28%
32R	205	481.7	3774.5	116.5	R	-14.301062	132.215160	139.06	456	Tree in group	1.90%
32R	219	489.8	3782.6	50.0	R	-14.301184	132.214974	139.54	458	Tree in group	1.96%
32R	222	492.9	3785.7	31.4	R	-14.301216	132.214921	141.17	463	Tree in group	2.28%
32R	208	513.9	3806.7	105.6	R	-14.301006	132.215061	139.90	459	Tree in group	1.94%
32R	229	521.9	3814.7	7.8	L	-14.301229	132.214759	138.93	456	Tree in group	1.73%
32R	227	536.9	3829.7	0.7	R	-14.301174	132.214747	140.02	459	Tree in group	1.88%
32R	206	541.4	3834.2	116.3	R	-14.300915	132.215028	142.24	467	Tree in group	2.28%
32R	210	541.7	3834.5	100.1	R	-14.300949	132.214986	139.91	459	Tree in group	1.84%
32R	225	544.0	3836.8	13.2	R	-14.301130	132.214763	140.05	459	Tree in group	1.86%
32R	234	548.5	3841.3	52.7	L	-14.301259	132.214587	140.66	461	Tree in group	1.96%
32R	136	579.8	3872.6	18.5	R	-14.301030	132.214698	139.84	459	Tree in group	1.71%
32R	129	593.3	3886.1	50.6	R	-14.300929	132.214749	141.31	464	Tree in group	1.92%
32R	146	595.6	3888.4	48.8	L	-14.301136	132.214493	139.91	459	Tree in group	1.68%
32R	148	604.3	3897.1	11.0	L	-14.301034	132.214569	140.68	462	Tree in group	1.78%
32R	214	604.8	3897.6	90.0	R	-14.300816	132.214823	141.96	466	Tree in group	1.99%
32R	209	605.0	3897.8	111.8	R	-14.300769	132.214877	143.77	472	Tree in group	2.29%
32R	212	619.2	3912.0	100.5	R	-14.300759	132.214818	141.81	465	Tree in group	1.92%
32R	149	621.8	3914.6	1.4	L	-14.300970	132.214555	141.06	463	Tree in group	1.79%
32R	231	625.6	3918.4	17.6	L	-14.300995	132.214506	139.51	458	Tree in group	1.53%
32R	207	631.5	3924.3	131.9	R	-14.300661	132.214869	142.55	468	Tree in group	2.00%
32R	200	636.0	3928.8	107.4	R	-14.300703	132.214798	144.72	475	Tree in group	2.33%
32R	213	639.1	3931.9	95.9	R	-14.300719	132.214762	142.89	469	Tree in group	2.03%
32R	185	658.7	3951.5	55.9	R	-14.300757	132.214619	140.33	460	Tree in group	1.58%
32R	216	661.0	3953.8	78.2	R	-14.300704	132.214670	141.69	465	Tree in group	1.78%
32R	130	666.9	3959.7	29.5	R	-14.300793	132.214534	139.27	457	Tree in group	1.40%
32R	138	667.9	3960.7	15.4	L	-14.300887	132.214419	138.98	456	Tree in group	1.36%
32R	186	690.6	3983.4	64.9	R	-14.300660	132.214571	142.17	466	Tree in group	1.78%
32R	232	702.9	3995.7	31.2	L	-14.300835	132.214302	141.42	464	Tree in group	1.64%
32R	139	729.5	4022.3	36.1	L	-14.300780	132.214232	140.49	461	Tree in group	1.45%
32R	253	772.2	4065.0	66.2	R	-14.300457	132.214395	139.69	458	Tree in group	1.27%
32R	255	820.0	4112.8	75.2	R	-14.300320	132.214313	140.81	462	Tree in group	1.33%
32R	257	986.3	4279.1	178.0	R	-14.295693	132.214207	142.30	467	Tree in group	1.26%
Coordinates of Take Splay Origins: RWY 14L						-14.314712	132.231284	134.54			
RWY 32R						-14.302492	132.215924	129.95			